

Web Version

R-E-S-I-D-E-N-T-I-A-L S-A-L-E-S & M-L-S

S-U-M-M-A-R-Y

w/ PHOTOS (2) & F-L-O-O-R P-L-A-N

Township Of Kingwood

JUL 2,2009

DAVID M GILL, CTA

138 MOUNTAIN ROAD

RINGOES NJ

08551

(609)466-1878

(908)996-3886

| | | | |
|-------------------|-------------------------|--------|-------------------|
| 22 | 208 READING ROAD | Land: | 181,600 |
| 17.06 | TAMMY SCIOSCIA | Improv | 447,800 |
| | 208 READING ROAD | Total | 629,400 |
| | FLEMINGTON NJ | | |
| | 08822 | | |
| PRC: 2 | AR-2 AR10 | | |
| Card #: 01 | 2.51 AC. | 2.51 | WET/CONSV: .66 AC |



Sales Information:

| | | | |
|-------------|--------------------|-------------|----------------------------------|
| Book, Page | Date, Price | Grantor: | BUNKER HILL HOMES INC |
| 2229 | MAR 11,2009 | Grantee: | SCIOSCIA, TAMMY |
| 20 | \$575,000 | Sales Code: | R307 RESIDENCE: Z: New Residence |

Ratio **109.46%** Per SF Asmt **\$167** Per SF Val **\$153**

Square Foot Areas:

| | | | |
|--------------------|--------------|---------------|--------------|
| 1st Story: | 2,382 | Basement: | 1,920 |
| Upper Story: | 1,838 | Liv Bsmt: | |
| Half Story: | | Fin Bsmt: | |
| Fin Attic: | | Slab: | |
| Ls: Unfin Area: | | Rooms: | |
| Ls: Built-Ins: | 462 | Rooms | 9 |
| | | Bedrms | 4 |
| | | Baths | 3.0 |
| S. F. L. A. | 3,758 | 4 Pc: | 1 |
| | | 3 Pc: | 2 |
| | | 2 Pc: | |
| | | 1 Pc: | |

Design:
COLONIAL

Building Desc / Model Name

Stories
2 STORY

Type
ONE FAMILY

Year Built / Eff Year
2008 2008

Heating System:
FORCED AIR

Air Conditoning:
AIR COND COMBIN

Class Net Cond:
18 100.0%



| | |
|-----------------------|--------------------|
| M L S Listing: | |
| Date: | DEC 22,2008 |
| Amount: | \$639,990 |
| D O M: | 230 |

Current Tax / Ratio

| | |
|-----------|---------------|
| Tax Year: | 2009 |
| Taxes: | |
| Tax Rate: | |
| Ratio: | 98.08% |

SKETCH

- A: 1S-B (26)
- B: 2CC-1S-B (320)
- C: 2CC-1S-B (198)
- D: 2S-B (1376)
- E: 2S-BIG (462)
- F: ATG (126)
- G: ATG (126)

Legend Square Footage is Perimeter !

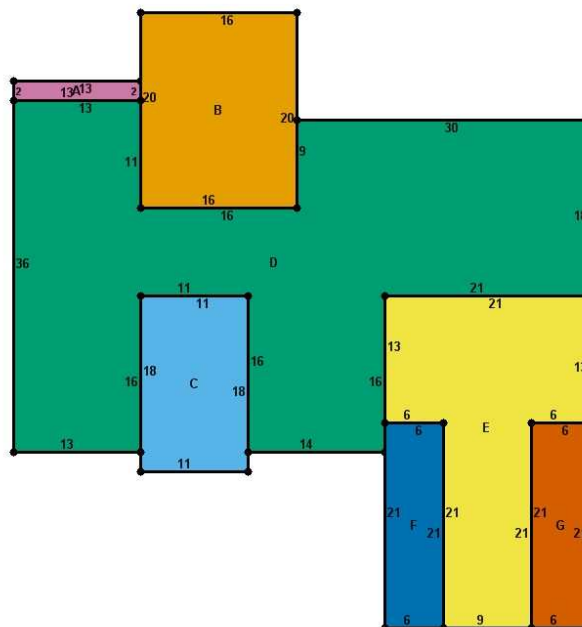

Last Bldg Permt / CO:

MAR 13,2009
CERT OF APPROVAL

Last Added Assmt:

SEP 28,2008
NEW RESIDENCE
\$447,800

| | | |
|-------------------|--------------------------|-----------------------|
| 23 | 154 THATCHER ROAD | Land: 209,800 |
| 13.17 | PAUL & BRANDEE POANDL | Improv 316,300 |
| | 154 THATCHER ROAD | Total 526,100 |
| | FRENCHTOWN NJ 08825 | |
| PRC: 2 | 2SF-2AG | AR-2 AR16 |
| Card #: 01 | 3.47 AC | 3.47 |



04.23.2009 14:22

Sales Information:

| | | |
|---|---|--|
| Book, Page 2229 254 | Date, Price JAN 23,2009 \$420,000 | Grantor: DZWONCZYK, PETER J & MELISSA R Grantee: POANDL, PAUL & BRANDEE Sales Code: R326 RESIDENCE: Z: Relocation Sale |
|---|---|--|

Ratio **124.10%** Per SF Asmt **\$204** Per SF Val **\$164**

Square Foot Areas:

| | | |
|---------------------------|------------------------|-----------------|
| 1st Story: 1,354 | Basement: 1,332 | |
| Upper Story: 1,206 | Liv Bsmt: | |
| Half Story: | Fin Bsmt: | |
| Fin Attic: | Slab: | |
| Ls: Unfin Area: | Rooms: | |
| Ls: Built-Ins: | Rooms 8 | Bedrms 4 |
| | Baths 2.5 | |

S. F. L. A. **2,560**

| | |
|--------------------------|--|
| M L S Listing: | |
| Date: DEC 22,2008 | |
| Amount: \$519,900 | |
| D O M: 42 | |

| |
|--|
| Design: COLONIAL |
| Building Desc / Model Name 2SF-2AG |
| Stories 2 STORY |
| Type ONE FAMILY |
| Year Built / Eff Year 2002 2002 |
| Heating System: FORCED AIR |
| Air Condiitoning: AIR COND COMBIN |
| Class 18 Net Cond: 100.0% |



04.23.2009 14:23

Current Tax / Ratio

| |
|-----------------------|
| Tax Year: 2009 |
| Taxes: |
| Tax Rate: |
| Ratio: 98.08% |

Prior Tax / Ratio

| |
|--------------------------|
| Tax Year: 2008 |
| Taxes: \$8,733.26 |
| Tax Rate: \$1.66 |
| Ratio: 98.73% |

Last Bldg Permt / CO:

| |
|--|
| |
|--|

Last Added Assmt:

| |
|--|
| |
|--|

SKETCH

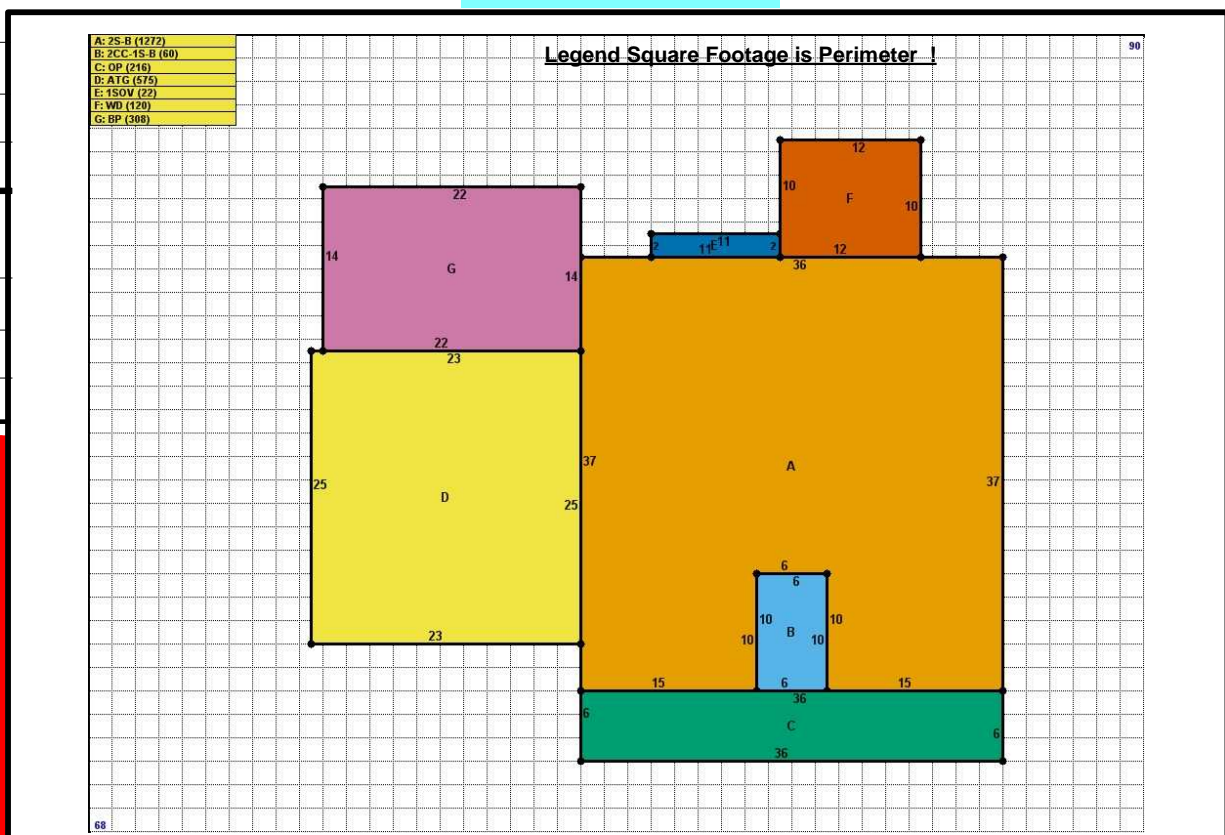

| | | | |
|-------------------|----------------------------------|--------|----------------|
| 29 | 200 KINGWD STA-BARBERTOWN | Land: | 218,600 |
| 7 | TAYLOR STROBER | Improv | 119,700 |
| | 47 FAIRVIEW ROAD | Total | 338,300 |
| | FRENCHTOWN NJ 08825 | | |
| PRC: 2 | 1SF | AR-2 | AR11 |
| Card #: 01 | 3.95 AC | | 3.95 |



| Sales Information: | | | |
|--------------------|-------------------|-------------|-----------------------------------|
| Book, Page | Date, Price | Grantor: | SIMEONE, CHARLES & MINDY A ELGART |
| 2224 | JAN 7,2009 | Grantee: | STROBER, TAYLOR |
| 349 | \$365,000 | Sales Code: | R1 RESIDENCE:MLS: |

Ratio **92.68%** Per SF Asmt **\$256** Per SF Val **\$276**

| Square Foot Areas: | | | |
|--------------------|--------------|---------------|--------------|
| 1st Story: | 1,014 | Basement: | 1,000 |
| Upper Story: | | Liv Bsmt: | |
| Half Story: | 308 | Fin Bsmt: | |
| Fin Attic: | | Slab: | |
| Ls: Unfin Area: | | Rooms: | |
| Ls: Built-Ins: | | Rooms | 5 |
| | | Bedrms | 2 |
| | | Baths | 2.0 |

| | |
|----------------------------|--------------------|
| Design: | CAPE COD |
| Building Desc / Model Name | 1SF |
| Stories | 1.5 STORY |
| Type | ONE FAMILY |
| Year Built / Eff Year | 1959 1959 |
| Heating System: | HOTWATER BB |
| Air Condiitoning: | NONE |
| Class | Net Cond: |
| 16 + | 80.0% |

| | |
|-----------------------|--------------------|
| S. F. L. A. | 1,322 |
| M L S Listing: | |
| Date: | DEC 22,2008 |
| Amount: | \$389,000 |
| D O M: | 152 |

| Current Tax / Ratio | |
|---------------------|-------------------|
| Tax Year: | 2009 |
| Taxes: | |
| Tax Rate: | |
| Ratio: | 98.08% |
| Prior Tax / Ratio | |
| Tax Year: | 2008 |
| Taxes: | \$5,615.78 |
| Tax Rate: | \$1.66 |
| Ratio: | 98.73% |

| |
|------------------------------|
| Last Bldg Permt / CO: |
| NO CERTIFICATE ISSUED |
| Last Added Assmt: |

SKETCH

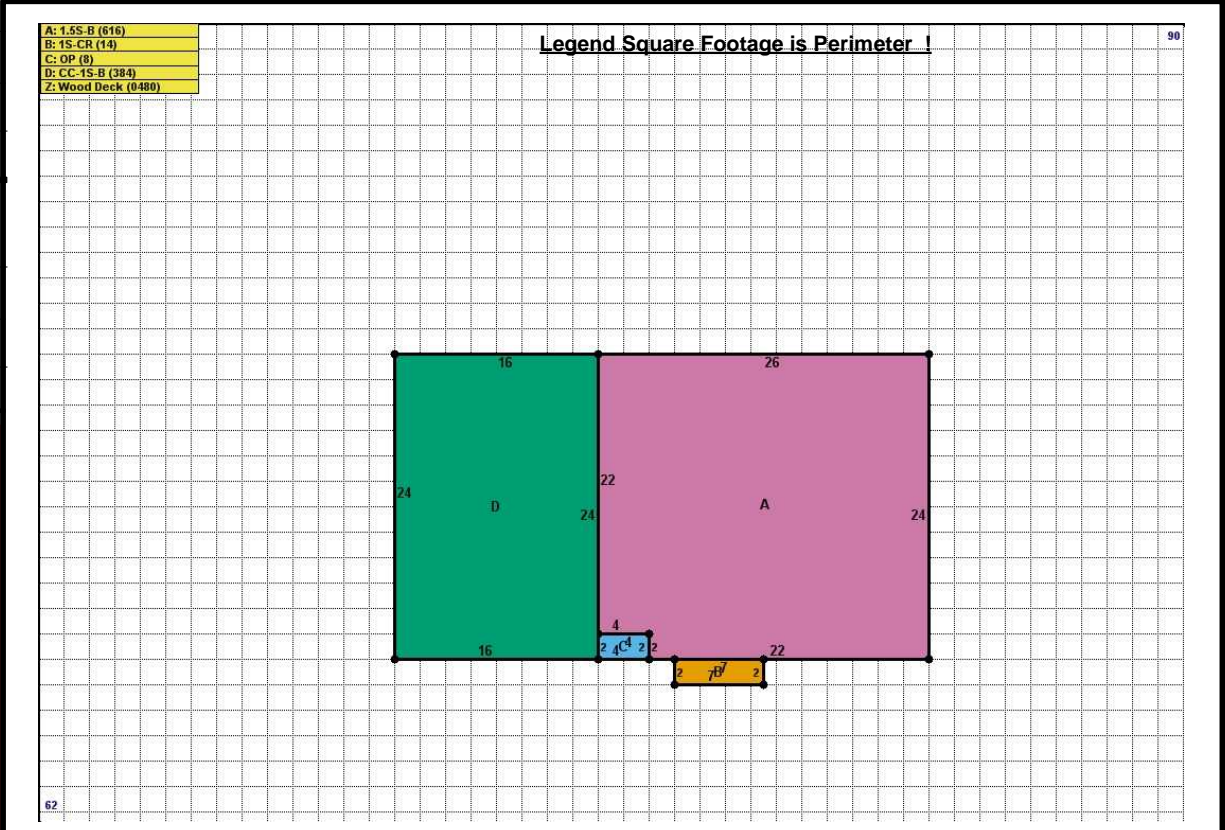

| | | | |
|-------------------|----------------------------|--------|----------------|
| 36 | 330 COUNTY ROAD 519 | Land: | 169,000 |
| 1 | MINDY ELGART | Improv | 84,400 |
| | 330 COUNTY ROAD 519 | Total | 253,400 |
| | STOCKTON NJ | | |
| | 08559 | | |
| PRC: 2 | 1SF | AR-2 | AR10 |
| Card #: 01 | .75 AC | | 0.75 |



Sales Information:

| | | | |
|-------------|-------------------|-------------|--------------------------|
| Book, Page | Date, Price | Grantor: | SMITH, FELIX & ELISABETH |
| 2224 | JAN 7,2009 | Grantee: | ELGART, MINDY |
| 515 | \$229,900 | Sales Code: | R1 RESIDENCE:MLS: |

| | | |
|----------------------|--------------------------|-------------------------|
| Ratio 110.22% | Per SF Asmt \$260 | Per SF Val \$236 |
|----------------------|--------------------------|-------------------------|

Square Foot Areas:

| | | | |
|-----------------|------------|---------------|------------|
| 1st Story: | 975 | Basement: | 825 |
| Upper Story: | | Liv Bsmt: | |
| Half Story: | | Fin Bsmt: | |
| Fin Attic: | | Slab: | |
| Ls: Unfin Area: | | Rooms: | |
| Ls: Built-Ins: | | Rooms | 3 |
| | | Bedrms | 1 |
| | | Baths | 1.0 |
| | | 4 Pc: | |
| | | 3 Pc: | 1 |
| | | 2 Pc: | |
| | | 1 Pc: | |

S. F. L. A. **975**

| | |
|---------------------|--------------------|
| MLS Listing: | |
| Date: | DEC 22,2008 |
| Amount: | \$249,900 |
| D O M: | 170 |

| | |
|----------------------------|-------------------|
| Design: | RANCHER |
| Building Desc / Model Name | 1SF |
| Stories | 1 STORY |
| Type | ONE FAMILY |
| Year Built / Eff Year | 1850 1850 |
| Heating System: | FORCED AIR |
| Air Condiitoning: | NONE |
| Class | 17 |
| Net Cond: | 80.0% |

Current Tax / Ratio

| | |
|-----------|---------------|
| Tax Year: | 2009 |
| Taxes: | |
| Tax Rate: | |
| Ratio: | 98.08% |

Prior Tax / Ratio

| | |
|-----------|-------------------|
| Tax Year: | 2008 |
| Taxes: | \$4,206.44 |
| Tax Rate: | \$1.66 |
| Ratio: | 98.73% |

Last Bldg Permt / CO:

| |
|--|
| |
|--|

Last Added Assmt:

| |
|--|
| |
|--|

SKETCH

