

SEE SHEET 3

SEE SHEET 3

SEE SHEET 5

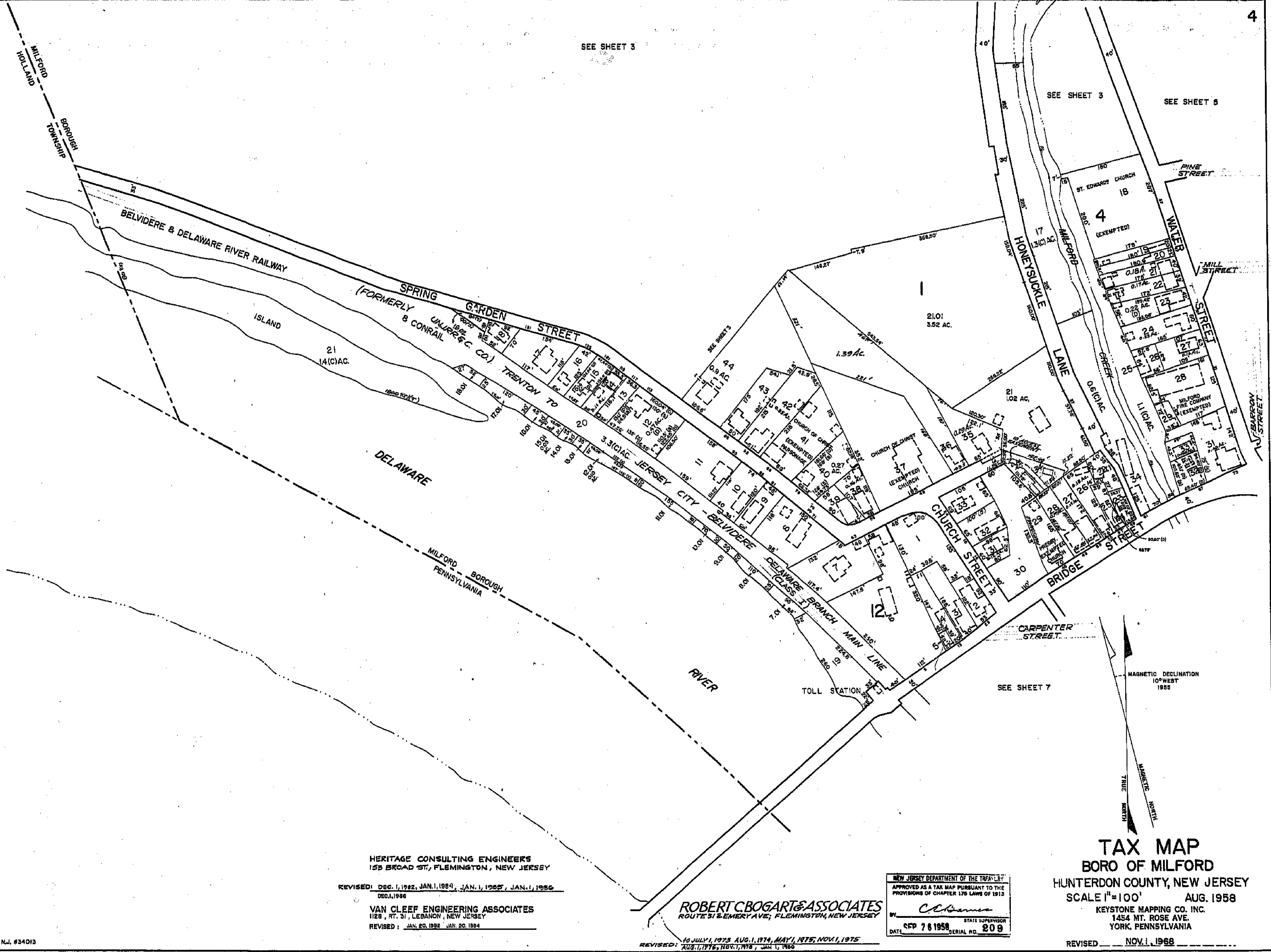

HERITAGE CONSULTING ENGINEERS  
153 BROAD ST., FLEMINGTON, NEW JERSEY  
REVISED: DEC. 1, 1982, JAN. 1, 1984, JAN. 1, 1985, JAN. 1, 1986  
DEC. 1, 1988

VAN CLEEF ENGINEERING ASSOCIATES  
1128 RT. 31, LEBANON, NEW JERSEY  
REVISED: JAN. 20, 1988, JAN. 20, 1984

ROBERT C. BOGART & ASSOCIATES  
ROUTE 31 & EMERY AVE., FLEMINGTON, NEW JERSEY

NEW JERSEY DEPARTMENT OF THE TREASURY  
APPROVED AS A TAX MAP PURSUANT TO THE  
PROVISIONS OF CHAPTER 170 LAWS OF 1913

*Robert C. Bogart*  
BY: STATE SUPERVISOR  
DATE: SEP 28 1988 SERIAL NO. 209

**TAX MAP**  
BORO OF MILFORD  
HUNTERDON COUNTY, NEW JERSEY  
SCALE 1"=100' AUG. 1958  
KEYSTONE MAPPING CO. INC.  
1454 MT. ROSE AVE.  
YORK, PENNSYLVANIA

REVISED NOV. 1, 1968

REVISED TO DEC. 12, 1969, REVISED TO JULY 1, 1973